

# Talk with your hands? You might think with them too

September 15 2022

---

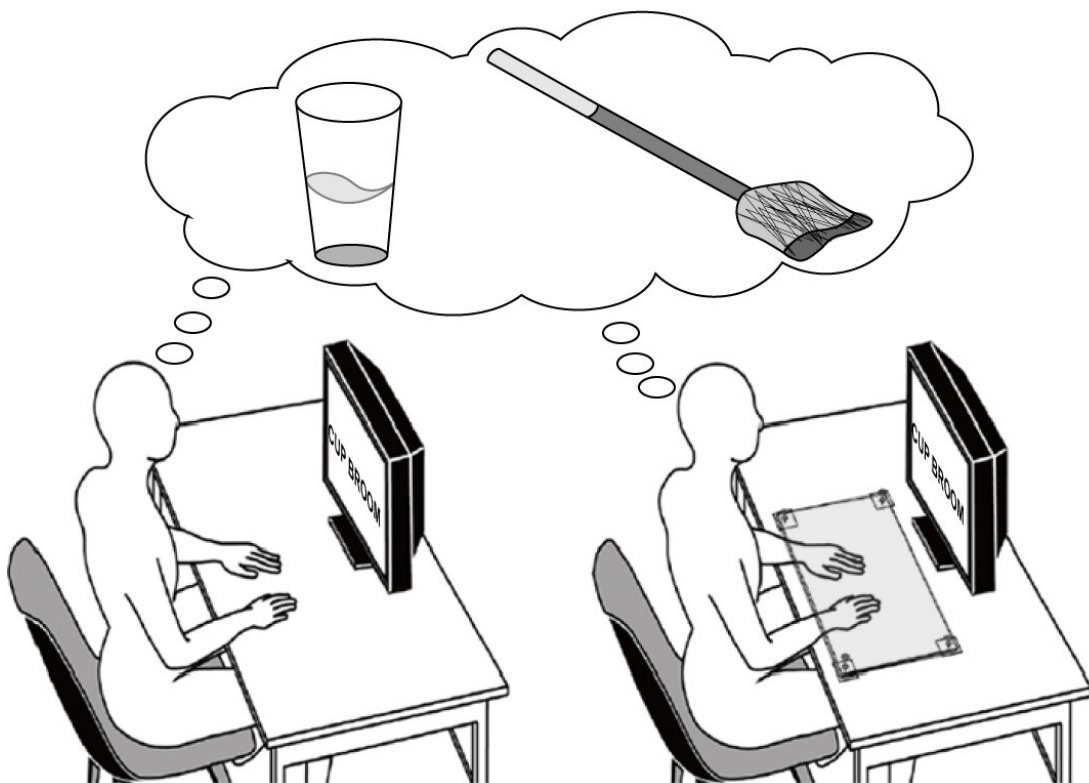

When asked about which word represented the larger object, participants answered faster when their hands were free (left) than when hands were restrained (right). Restraining hands also lowered brain activity when processing words for hand manipulable objects in left brain areas associated with tools. Credit: Makioka, Osaka Metropolitan University

How do we understand words? Scientists don't fully understand what happens when a word pops into your brain. A research group led by Professor Shogo Makioka at the Graduate School of Sustainable System Sciences, Osaka Metropolitan University, wanted to test the idea of embodied cognition. Embodied cognition proposes that people understand the words for objects through how they interact with them, so the researchers devised a test to observe semantic processing of words when the ways that the participants could interact with objects were limited.

Words are expressed in relation to other words; a "cup," for example, can be a "container, made of glass, used for drinking." However, you can only use a cup if you understand that to drink from a cup of water, you hold it in your hand and bring it to your mouth, or that if you drop the cup, it will smash on the floor. Without understanding this, it would be difficult to create a robot that can handle a real cup. In [artificial intelligence research](#), these issues are known as symbol grounding problems, which map symbols onto the real world.

How do humans achieve symbol grounding? Cognitive psychology and [cognitive science](#) propose the concept of embodied cognition, where objects are given meaning through interactions with the body and the environment.

To test embodied cognition, the researchers conducted experiments to see how the participants' brains responded to words that describe objects that can be manipulated by hand, when the participants' hands could move freely compared to when they were restrained.

"It was very difficult to establish a method for measuring and analyzing [brain activity](#). The first author, Ms. Sae Onishi, worked persistently to come up with a task, in a way that we were able to measure brain activity with sufficient accuracy," Professor Makioka explained.

In the experiment, two words such as "cup" and "broom" were presented to participants on a screen. They were asked to compare the relative sizes of the objects those words represented and to verbally answer which object was larger—in this case, "broom." Comparisons were made between the words, describing two types of objects, hand-manipulable objects, such as "cup" or "broom" and nonmanipulable objects, such as "building" or "lamppost," to observe how each type was processed.

During the tests, the participants placed their hands on a desk, where they were either free or restrained by a transparent acrylic plate. When the two words were presented on the screen, to answer which one represented a larger object, the participants needed to think of both objects and compare their sizes, forcing them to process each word's meaning.

Brain activity was measured with functional near-infrared spectroscopy (fNIRS), which has the advantage of taking measurements without imposing further physical constraints. The measurements focused on the interparietal sulcus and the inferior parietal lobule ([supramarginal gyrus](#) and angular gyrus) of the left brain, which are responsible for semantic processing related to tools. The speed of the verbal response was measured to determine how quickly the participant answered after the words appeared on the screen.

The results showed that the activity of the left [brain](#) in response to hand-manipulable objects was significantly reduced by hand restraints. Verbal responses were also affected by hand constraints. These results indicate that constraining hand movement affects the processing of object-meaning, which supports the idea of embodied cognition. These results suggest that the idea of embodied cognition could also be effective for [artificial intelligence](#) to learn the meaning of objects. The paper was published in *Scientific Reports*.

**More information:** Sae Onishi et al, Hand constraint reduces brain activity and affects the speed of verbal responses on semantic tasks, *Scientific Reports* (2022). [DOI: 10.1038/s41598-022-17702-1](https://doi.org/10.1038/s41598-022-17702-1)

Provided by Osaka Metropolitan University

Citation: Talk with your hands? You might think with them too (2022, September 15) retrieved 10 April 2024 from <https://medicalxpress.com/news/2022-09-talk-with-your-hands-you.html>

This document is subject to copyright. Apart from any fair dealing for the purpose of private study or research, no part may be reproduced without the written permission. The content is provided for information purposes only.